

NEW ADDITION TO THE SUPERPLUS FAMILY

SORMAT-LIEBIG BLS is the ONLY true self-undercutting anchor on the market!

Simple and quick installation

- no special and costly stop drilling tools
- no special undercut tools
- no special setting tools

Self undercutting simply by tightening

Long term clamping forces

- preload is totally converted to clamping force
- fixture does not come loose during service life
- no re-tightening required during service life

With the new BLS-P the same ease-of-use is available for pre-set applications.

Applications requiring

- distance mounting
- flexible fixture thickness
- smaller hole in the fixture



BLS
M12-20/80/15

BLS-P
M12-20/80/15



SORMAT.
COM



TYPE BLS-P

Simply the best heavy duty self-undercutting anchor in the world for pre-set installations

APPLICATIONS

- Elevators
- Power plants (e.g. Nuclear)
- Safety and crash barriers
- Heavy hydraulic pipe support
- Façade elements on slim base material
- Tunnel ventilation
- Cranes and crane runways
- Steel structures
- Machines
- Base plates

APPROVALS



STANDARD RANGE

- **BLS-P M12-20/80/15**
art. BLS-P1220080015
- **BLS-P M12-20/150/30**
art. BLS-P1220150030
- **BLS-P M16-25/150/40**
art. BLS-P1625150040
- **BLS-P M16-25/200/40**
art. BLS-P1625200040

PRODUCT DESCRIPTION

- Unique automatically self-undercutting, heavy duty anchor for pre-set installations.
- Pre-set installation benefits:
 - distance mountings possible
 - flexible fixture thickness
 - smaller holes in fixture
- Simplest, quickest and safest solution on the market.
- Economical: No special drill bits, undercut tools or setting tools.
- Easy overhead installation.
- Minimal expansion forces allow for small spacings and edge distances.
- Seismic tested acc. ACI 355.2-04.
- Fire approved acc. TR020.
- ZP for dry indoor and temporary outdoor use.

BASE MATERIALS

- **Approved base materials:**
Cracked concrete
Non-cracked concrete

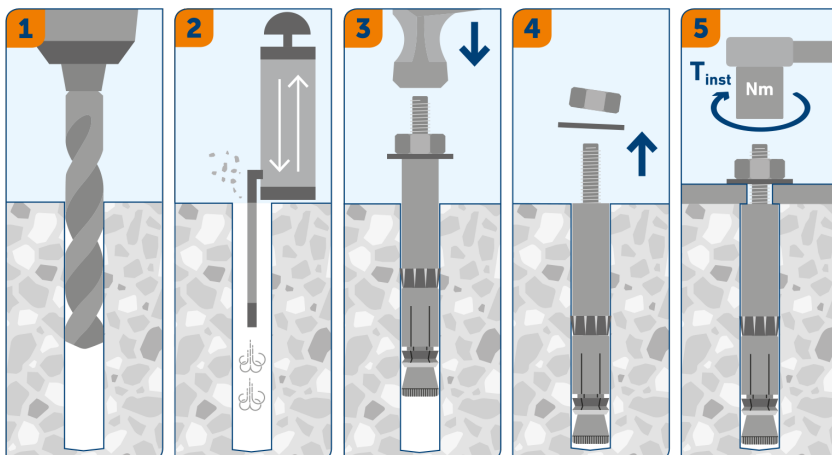

INSTALLATION

1. Drill a hole according to the product data.
2. Clean the hole.
3. Install the anchor with hammer.
4. Remove the nut and washer.
5. Tighten the anchor to the specified installation torque.



sormat.com